

Buffalo Bayou
Partnership

The Warehouse at Turkey Bend

EVENT VENUE GUIDE



About

The Warehouse at Turkey Bend on Buffalo Bayou is a newly renovated historic venue available for event rentals of many sizes and scales in Houston's vibrant East End neighborhood. The expansive and dramatic formerly industrial property is uniquely located at the confluence of Buffalo Bayou and Navigation Boulevard.

The thoughtfully repurposed industrial structure features an expansive open-air breezeway, exposed steel beams, restored wood plank ceilings, large ceiling fans, refinished cement floors, and brick walls featuring remnants of the site's iconic graffiti. Adjacent enclosed galleries on the north and south ends of the breezeway provide climate-controlled options for meetings, pop-ups, and staging. A central skylight illuminates a raised circular platform encircled by a spiraling ramp leading to a graffiti-lined art tunnel and the lower portion of the site. The large doorways on the north end of the building offer the opportunity for guests to enjoy views of Buffalo Bayou along a tree-lined path landscaped with native flora.

Location

5803 Navigation Boulevard, Houston TX 77011

Capacity

Capacity for all spaces (Breezeway + Galleries) is 660

To learn more and schedule a tour, please contact:

Rebecca Leija

rleija@buffalobayou.org

713.752.0314 ext. 101



Spaces



Breezeway

The Warehouse Breezeway is an open-air plaza tailored to the Houston climate with a grand entrance from Navigation Boulevard and expansive bayou views from an elevated vantage point.

Through natural cross ventilation, shade, and large fans, the Breezeway offers a unique and cool venue for year-round events. By opening the restored Navigation Boulevard façade, the Breezeway welcomes the community into the warehouse and is available for private event rentals of many sizes and scales. A large skylight filters natural light onto a raised, circular platform which offers an ideal setting for performances, a cocktail bar, presentations, dance floor, or display space.

DETAILS

Breezeway Area

14,300 sq ft.

Seating Area

4,000 sq ft.

Platform

1,350 sq ft.



Galleries

Two enclosed, fully air-conditioned suites—the North and South Galleries—facing the Breezeway are available. These spaces may be rented individually or in conjunction with the Breezeway to serve such functions as green room, staging area for catering, or meeting room. The South Gallery includes Navigation Boulevard street level access through a garage-style and swing door. With large windows facing north, the North Gallery provides guests with dramatic views of the bayou and surrounding industry. Both are accessible via a back-of-house service corridor.

SOUTH GALLERY DETAILS

Area

2,900 sq ft. with additional 280 sq ft. street level area

NORTH GALLERY DETAILS

Area

2,550 sq ft.



SOUTH GALLERY



NORTH GALLERY

Floor Plan

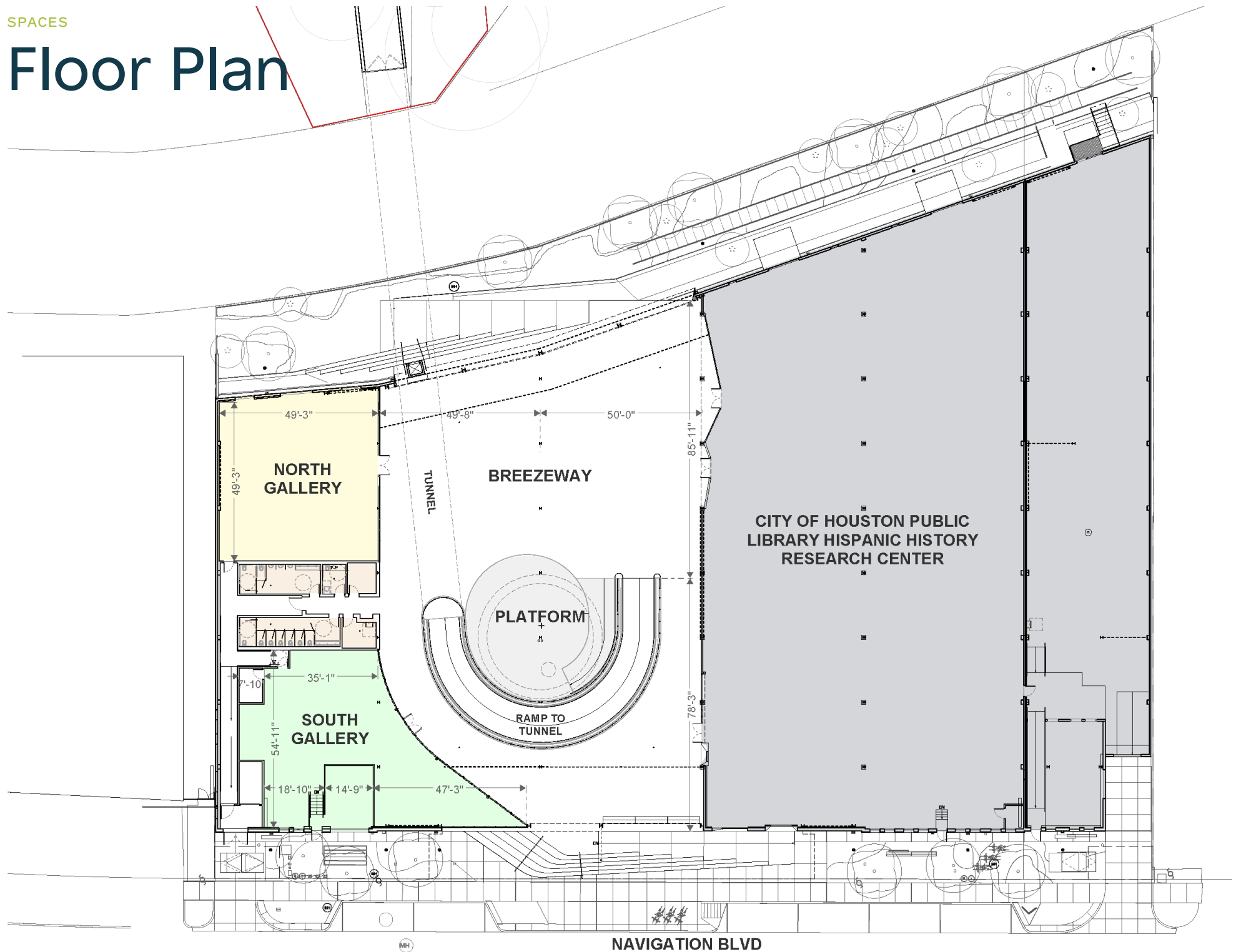

History

Turkey Bend on Buffalo Bayou represents a convergence of Houston's industrial legacy and a vision for a community-centered future.

Established in 1938 by The Shippside Contracting Co., the 4.2-acre Turkey Bend complex, located on a sprawling waterfront site, began its industrial life facilitating the transfer of shipped goods between street level trucks, rail cars, and barges traveling to the Port of Houston and Ship Channel. Various types of cargo passed through the barge terminal and warehouse over the years, including coffee for the numerous roasters in the East End, and structural steel components for which the large, exposed gantry crane on the wharf was built.

Buffalo Bayou Partnership (BBP) acquired the complex in 2018 and, in 2025, completed the renovation of the warehouse. As the project continues over the coming years, it will become the home of Houston Public Library's Hispanic History Research Center and Archives and its ramp and tunnel will provide direct pedestrian access to a revitalized waterfront wharf and boating hub.



Contact

Turkey Bend on Buffalo Bayou

5803 Navigation Boulevard

Houston TX, 77011

Venue Contact

Rebecca Leija

rleija@buffalobayou.org

Established in 1986, Buffalo Bayou Partnership (BBP) is the nonprofit organization creating and stewarding welcoming parks, trails, and unique spaces, connecting Houstonians with the city's most significant natural waterway. BBP focuses on a 10-mile stretch of Buffalo Bayou, from Shepherd Drive through downtown, into the East End, and on to the Port of Houston Turning Basin. In addition to spearheading and maintaining award-winning green spaces such as Buffalo Bayou Park, BBP also removes trash from the waterway, restores and preserves natural habitats, and engages tens of thousands of visitors each year through dynamic programming, public art, volunteer events, and recreational opportunities.

Venue rentals of Turkey Bend directly support BBP's mission and work.

IMAGE CREDITS: MELISSA TAYLOR, GEOFF LYON



Buffalo Bayou
Partnership

BUFFALOBAYOU.ORG
[@BUFFALOBAYOU](https://www.instagram.com/BUFFALOBAYOU)